

YAMHILL COUNTY SURVEY DEPARTMENT

The $\frac{1}{4}$ corner between Sections 7 and 8, T3S R6W, Willamette Meridian, Yamhill County, Oregon. 36200540

A 1940 dependent resurvey by the GLO calls for a brass cap monument set at the position of original stone, badly shattered with visible markings. New trees marked were:

A Cedar, 36" diam., bears S 28°45' E, 99 links distant, marked $\frac{1}{4}$ S8 BT.

A Fir, 48" diam., bears S 28°30' W, 38 links distant, marked $\frac{1}{4}$ S7 BT.

August 18, 1999:

The brass cap monument was recovered and is in good condition, up 8 inches. The 1940 fir bearing tree is now a 54" diameter cut stump with a healed face and is near the top of the road cut, Ginger Creek Road. The cedar tree marked in 1940 is also a cut stump, 42 inches in diameter with a rotted face and is in the road fill.

New bearing trees marked are:

A Cedar, 12" diam., bears N 4° E, 20.9' dist., tagged and scribed $\frac{1}{4}$ S8 BT.

A Cedar at the top of the road cut, 7" diam., bears N 55° E, 13.0 feet distant, tagged and scribed $\frac{1}{4}$ S8 BT.

A Douglas Fir, 12" diam., bears S 35° W, 19.4' dist., tagged and scribed $\frac{1}{4}$ S7 BT.

A Douglas Fir, 15" diam., bears S 73° W, 16.5' dist., tagged and scribed $\frac{1}{4}$ S7 BT.

The corner is 25 feet Northerly of the center of Ginger Creek Road at approximately 450 feet Northwest of its junction with the Nestucca River access road. The monument is about 10 feet from the top of the road cut.

Bearings are magnetic, 20° variation.

Report by: Lawrence Jones 08-23-1999

Checked by: Marty Glass 09-13-1999

Field team:

Lawrence E. Jones

Bob D. Gilson

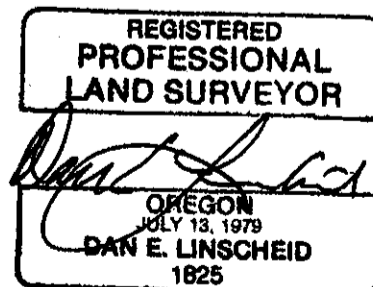

Renewable 06-30-2000
Yamhill County Surveyor